

ENGLISH

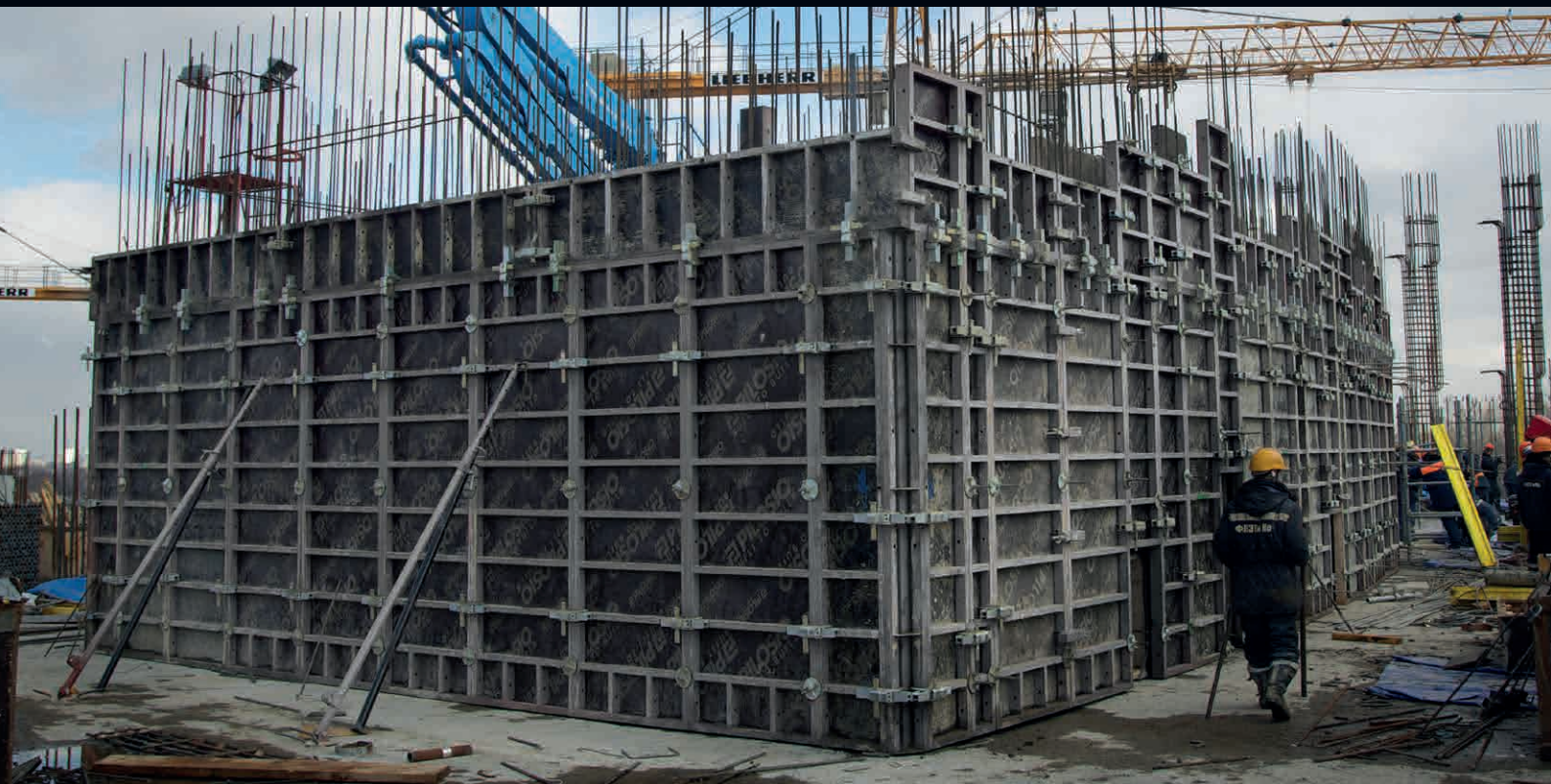

# FORMWORKS P300

 Made in Italy









## P300

It is a universal modular formwork system suitable for any type of site where vertical structures cast on site must be built. **P300** panels are the best compromise between productivity and overhead cost savings. They are simple and sturdy and thanks to their modularity they are suitable both for small medium-size sites and for large ones to build walls, bearing walls, pillars, single sided walls, plinths, and concrete pier caps.

Frame: height 100 mm, finishing: hot-dip galvanized.

### APPLICATIONS

- foundation plinths and curbs
- pillars
- bearing walls and walls in general
- lift wells
- stairwells
- single sided castings

**P300** formworks belong to Class 7 according to **prEN 15113-1** standards.

Maximum resistance to concrete pressure:

- standard **P300** panel 100x300: 60 kN/m<sup>2</sup>
- adjustable **P300** panel for columns 100x300: 80 kN/m<sup>2</sup>

### CHARACTERISTICS OF MATERIALS

To ensure high standards of quality and durability, the steel frame is hot-dip galvanized.

The multi-layer panel is 18 mm thick with phenolic surface film protection (220 g/m<sup>2</sup>). It consists of 11 layers of birch and has no moisture absorption when panel is protected. The edges are protected with paint and it can be used about 100 times per side. The weight is 11.35 kg/m<sup>2</sup>.



## CHARACTERISTICS

Base panel sized 100x300 cm is equipped with a few simple accessories, such as a quick connection block that allows quick handling and assembly. The frame is painted and the counter-casting surface consists of a Finnish plywood panel, 18 mm thick, that ensures high number of reuses.

It is available in the following sizes:

### AVAILABLE SIZES

H 300 cm	H 150 cm	H 100 cm	adjustable panel for pillars
100x300	100x150	100x100	100x300
200x300			100x150
90x300*	90x150*	90x100*	100x100
80x300*	80x150*	80x100*	
70x300	70x150	70x100	
60x300	60x150	60x100	
50x300	50x150	50x100	
40x300	40x150	40x100	
30x300	30x150	30x100	
20x300	20x150	20x100	

\*on request

Panels can be used both vertically and horizontally.

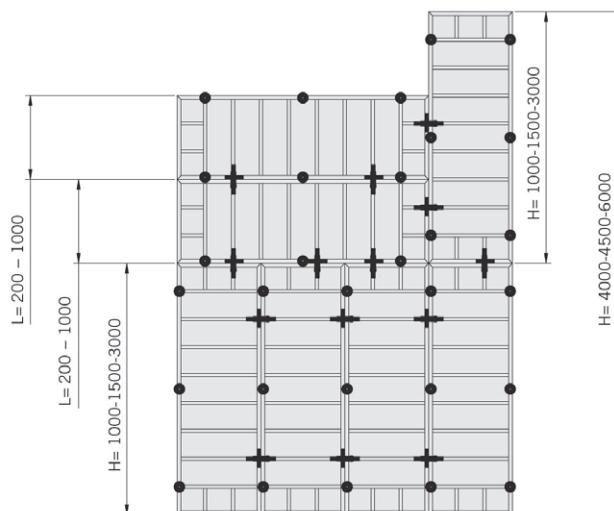

The **P300** connection block allows connecting staggered panels for casting over sloped surfaces with steps.

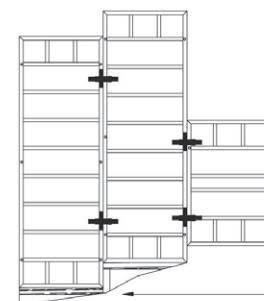

Stop footing

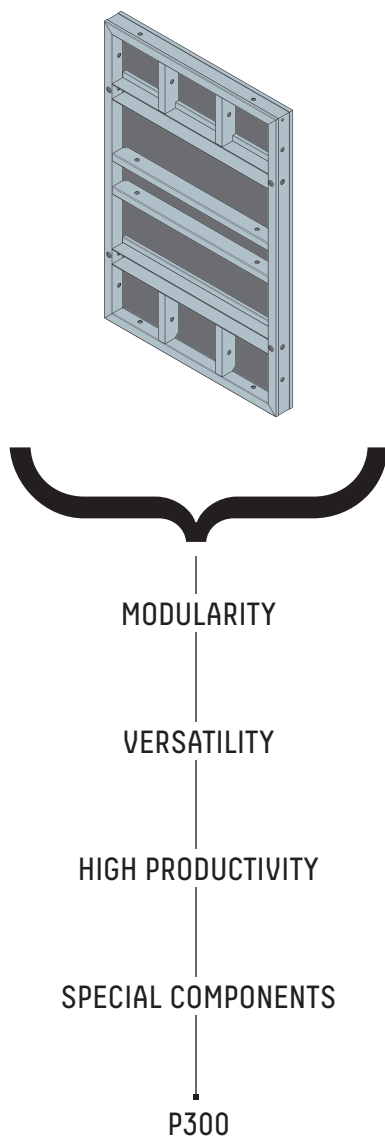

## STRENGTHS

- high panel modularity and great versatility of use
- panels can be used both vertically and horizontally
- wide availability of undersized panels, tie rods and plywood panels to obtain proper centering
- the panels can be reinforced when inclined, maximum inclination angle 7 degrees
- wide range of accessories for every need (angular hinges, service brackets, panel sealing, support brackets, contrast beams)
- four different options to reinforce the corner nodes according to the needs of the site
- containers for **P300** panels for quick and safe handling and storage of material
- it is possible to overlap the containers of panels to optimize the storage
- **special applications:** special formworks can be designed and manufactured by **Pilosio** in metal structural or, in combination with standard **P300** formworks.

## CHARACTERISTICS OF THE BASE PANEL 100X300

Reinforced surface m <sup>2</sup>	3
Connecting accessories	2 connection clamps
Threaded tie rods	3
Incidence of tie rods per m <sup>2</sup>	1
Multi-layered characteristics	18 mm 13 ply-birch – 220 gr. film/m <sup>2</sup>
Use per multi-layered side	100
Formwork capacity	60 kN/m <sup>2</sup> (80 kN/m <sup>2</sup> pillars)
Element weight	110 kg
Incidence kg/m <sup>2</sup>	36,66
Manual handling	NO
Special panel for pillars	YES

## CONSUMABLE MATERIALS

PVC caps	3
PVC spacers	3
PVC conic spacers	6
Disarming	YES

## CONNECTION SYSTEM

The **P300** connection clamp ensures quick assembly and perfect alignment of formworks

**Spacing:** 1 clamp every 1.5 m<sup>2</sup>.

### Advantages:

- quick assembly and disassembly
- alignment and perfect panel coplanar joint, ease of use in any situation
- it is sufficient to apply a hammer blow from top to bottom to close the clamp.

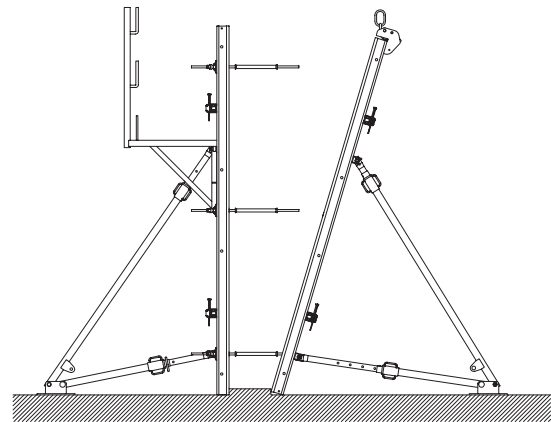
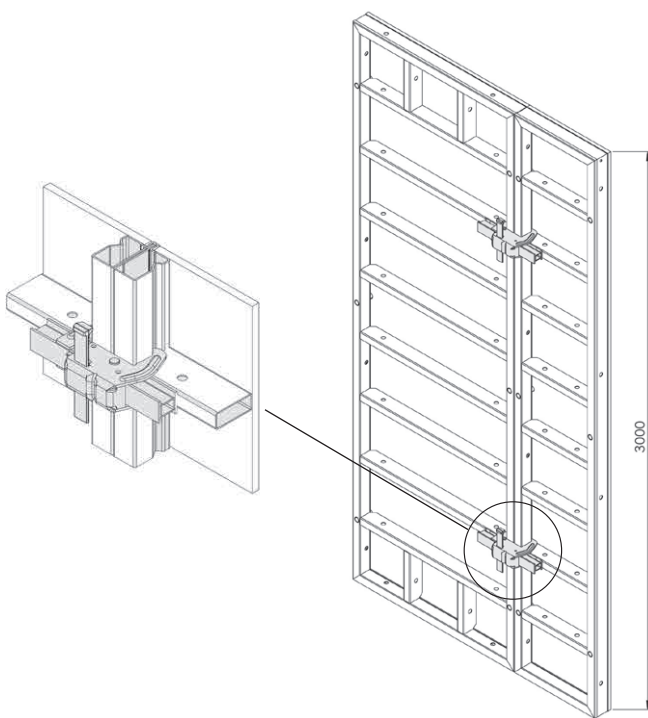

Formwork installation.

**P300** panels can be reinforced when inclined, both vertically and horizontally up to a maximum inclination of 7° respect to the vertical line. Horizontal panels with plywood alternated between panels are used for greater inclinations.

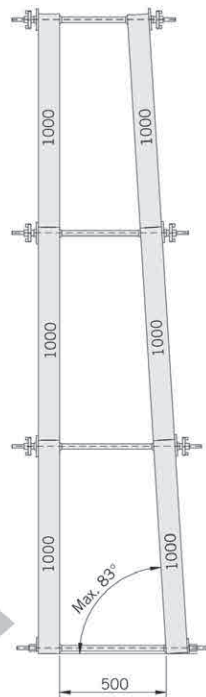

Panel installed horizontally →

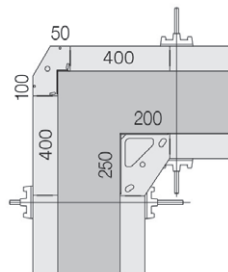
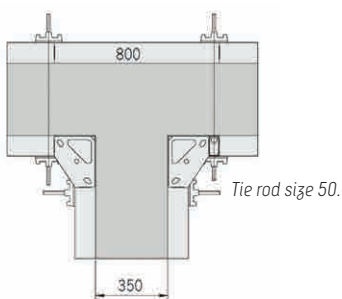

Angular panels to create corner nodes and "T" shaped nodes.





Possible dimensions of pillars in cm

X	200	250	300	350	400	450	500	550	600	650	700	750	800	850
Y	260	310	360	410	460	510	560	610	660	710	760	810	860	910

ACCESSORIES

Adjustable panels for casting pillars with dimensions from 20 to 85 and adjustment every 5 cm. Maximum resistance to casting pressure: 80 kN/m<sup>2</sup>).

The adjustable panels have been re-designed to offer a better quality of concrete cast finishing.

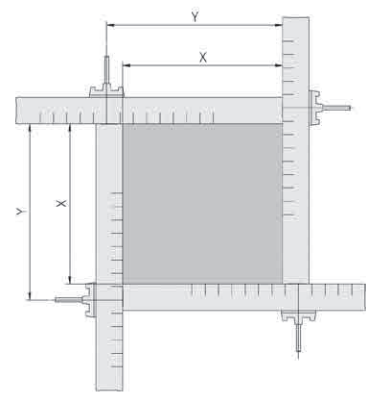
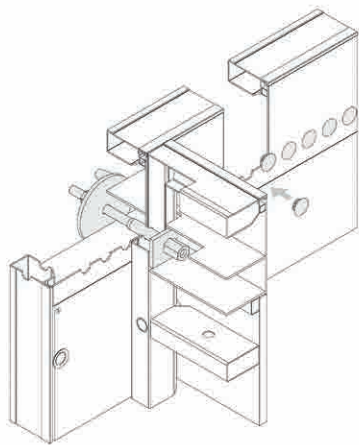
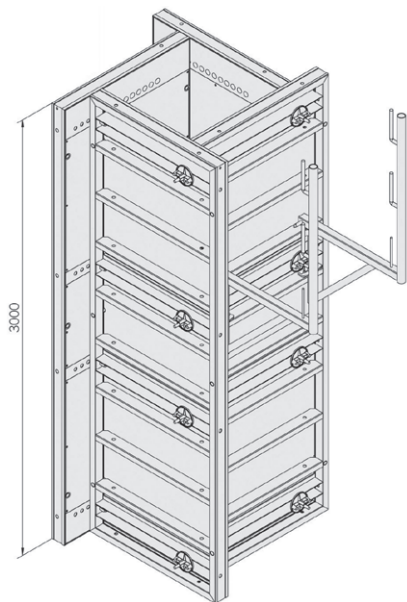

## STRIPPING CORNER WITH THREAD

With this new product, it is possible to detach the whole core formwork from the concrete wall and lift it by crane to the next level.

The main features of this product are:

- these corners can be stacked vertically together
- the striking of the complete formwork is localized at corner positions
- there is no negative impression on the concrete surface
- the whole inner formwork of the core can be lifted in one phase

They can be connected to the formwork panels with clamps or bolts, in any case the maximum pressure allowable on the formwork is guaranteed.

The new Stripping Corners with thread are available for all our systems of formworks (**MAGNUM 2.0, P300 and MINIMAG**)

To act on the Stripping Corner with thread, you only need a tie-rod 15mm connected to one of the holes in the threaded nut. Rotating the spindle nut clockwise or anti-clockwise, the Stripping Corner will close or open the formwork unit.

### Stripping play

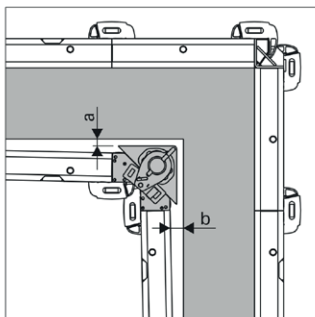
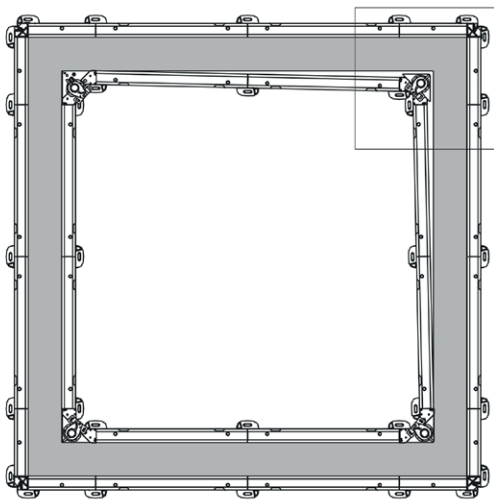

a = 3.0 cm  
b = 6.0 cm

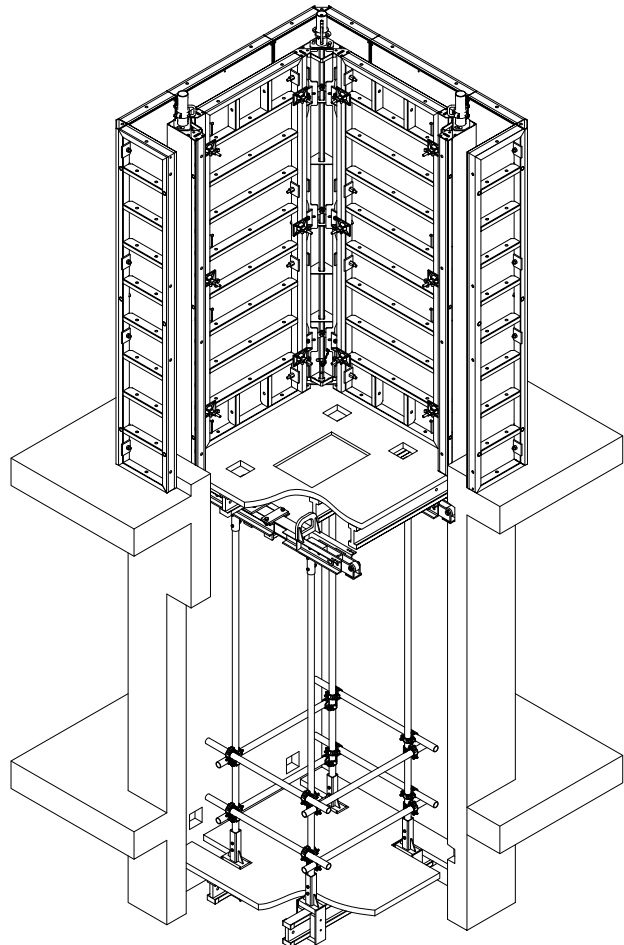



## SPECIAL APPLICATIONS

For special site requirements, the technical department of **Pilosio** designs and manufactures in carpentry all the necessary components for casting of non-standard structures.

For the casting of circular tanks the **P300** panels are assembled with special plywood that allows following the curvature of the structure.

*The **P300** formwork combined with special parts created for that purpose, is suitable to reinforce structures of large dimensions such as shoulders for viaducts and circular tanks.*

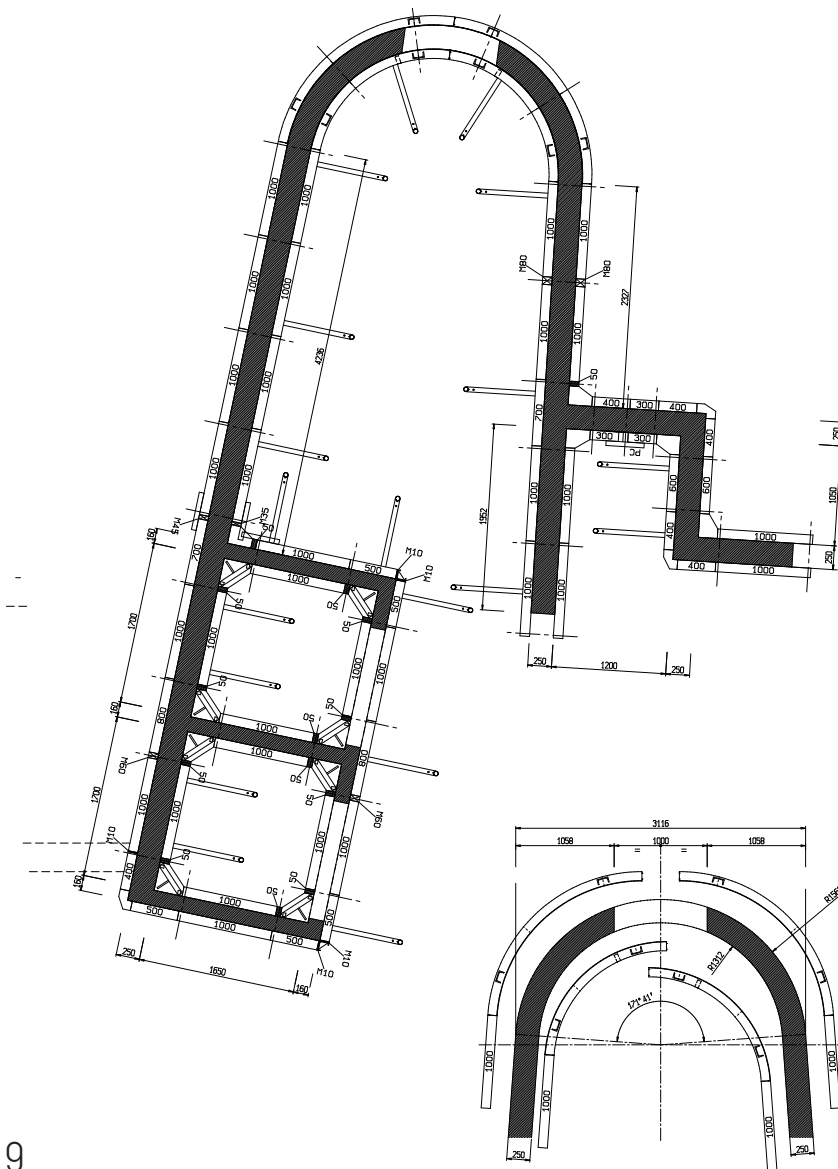
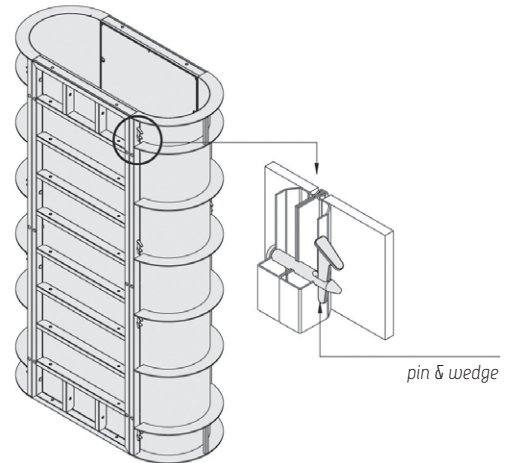

**SPECIAL APPLICATION WITH P300 PANELS** Stairwells with semi-circular partition manufactured with special curved formworks, combined with standard **P300** formworks.